

# Training Room for Netflix Animation



# Narrative

The room is designed to be easy for a trainer to walk in and easily demonstrate, record, and stream with high quality audio and video. They need to be able to share their screen, voice, computer audio, face/body, and whiteboard. Their voice needs to be recorded and amplified in the room.

The desk layout allows the instructor to see what all the students are doing on their screens - they will be facing away from the instructor. When they are facing the instructor who is giving a demonstration, they will not have a distracting computer screen in the way.



# Narrative (continued)

When the learners are following along, they can see what the instructor is doing on the wall mounted monitors. These are also handy when the instructor is giving a presentation, because they can look in any direction and see where they are, without having to awkwardly look at the screen behind them.

The open space in the middle allows for flexibility. If the training needed is a presentation with no hands-on work, the room can be filled with folding chairs, increasing the capacity significantly. It could also be used for things like figure drawing, group discussions, artist brainstorming sessions, artist dailies, collaborative events such as hackathons.





# Narrative (continued)

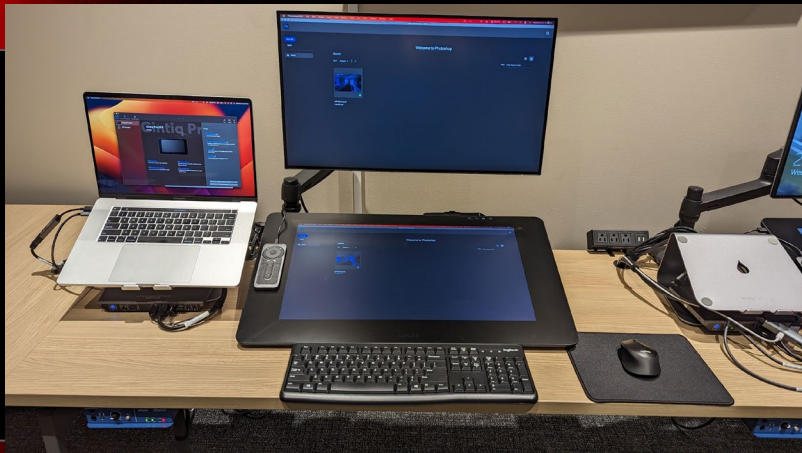
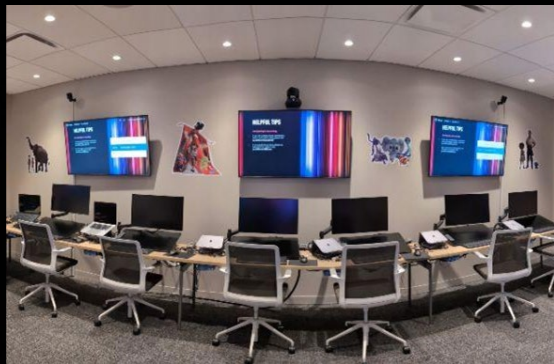

# Room Design

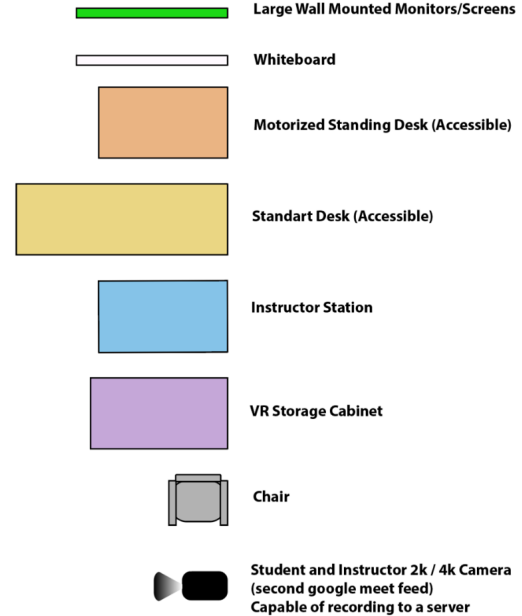
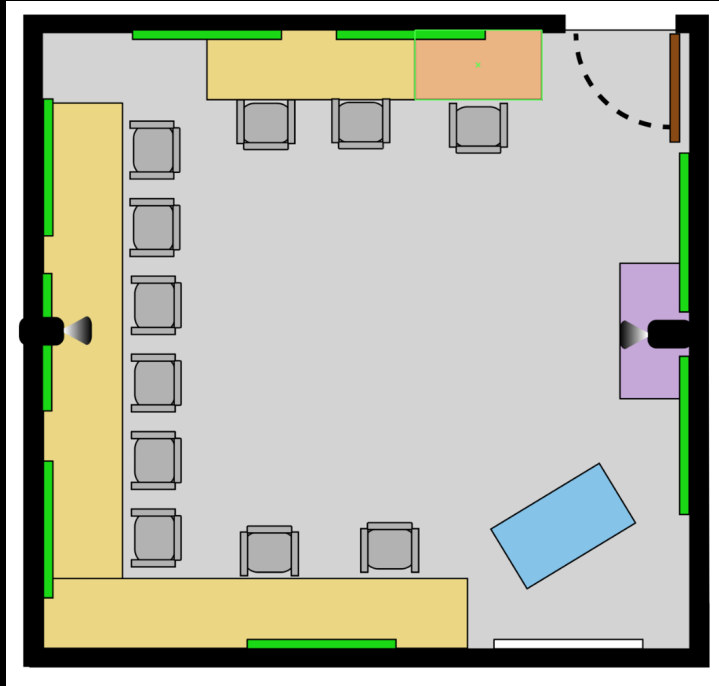

# Instructor Station

- 1 Instructor Monitor that can be sent to all wall screens in the room
- 1 Touch Screen Google Meet control monitor
- 1 Thin Client to access Virtual Workstations
- 1 Laptop stand and connections (PC/MAC)
- 1 Second auxiliary connection for second computer if needed
- Lift Switch to raise or lower desk
- Cintiq Tablet
- Pearl Recording system and Mics



# Instructor Station (continued)

## Under the Instructor Station



- 2 Pearl remote lapel mics
- 2 Pearl Wireless Hand Mics
- Mic Charging bases
- 6 Wireless earpieces for Hearing Impaired
- Room has Mic Stand

## Instructor Rack Thin Client and Pearl Recorder



## Laptop Connection PC or MAC



USB-C Hub and USB-C adapter or HDMI (Check your computers inputs and ask if you need help)

Both must be connected to your laptop. If you're on a Windows PC, you need to still have your power plugged in. This won't charge your laptop



USB-C Hub and USB-C adapter or HDMI (Check your computers inputs and ask if you need help)

Both must be connected to your laptop and if you're on a Mac, this will also charge your laptop so you don't need to plug in power

- 2 USB-C cables are used to connect your laptop to the instructor or student stations
- 1 GB Upload and download through USB
- Each laptop / thin client can present to a Meet or to screens in the training room
- MAC laptops are charged while connected (PC Laptops require their own power cable)
- KVM Switcher switches between laptop and thin client



# Instructor Station Control Center

## Room Control Home

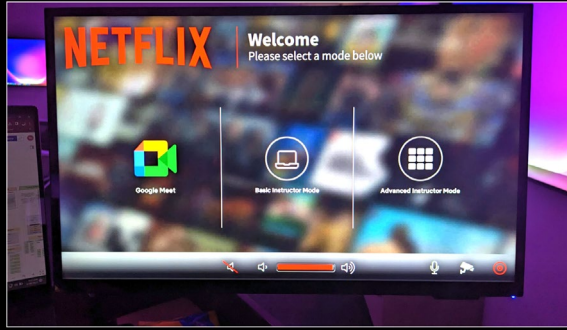

This is a Google Meet System! From the touch screen console, you can control the Meet, control recording from Google Meet and the Pearl system tied to what you are presenting, 2 cameras that can view and record up to 4k, and all the wall screens.



- Touch Screen
- Google Meet controls and calendar
- Google Meet and Pearl Recordings
- Camera Controls (selector, zoom, position)
- Quick Preset Menus
- Advanced Configuration
- Screen / Presentation Sharing from Student Screens (What is displayed on the Dell Monitors at the student stations)



# Learner Station

Learner Station  
Thin Client Configuration

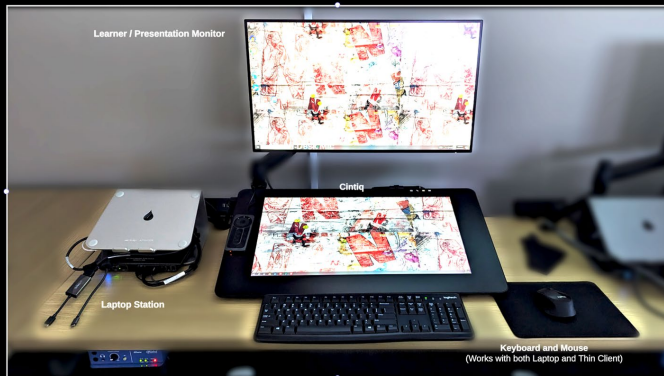

Sound Box for Headphones  
Can be used for editing or  
listening to Tutorials

Each Learner Station is equipped for learners that either use a Thin Client or have their own Laptop and include:

- 2 USB-C to connect if you have either a Mac or PC laptop
- 2nd Monitor
- Cintiq
- Keyboard and Mouse
- Soundbox for headphones or editing

Learner Station  
Laptop Configuration



KVM Switch  
1 = Thin Client / 2 = Laptop

- Laptop Stand
- 1 GB Upload and download through USB
- Each laptop / thin client can present to a Meet or to screens in the training room
- MAC laptops are charged while connected (PC Laptops require their own power cable)
- KVM Switcher switches between laptop and thin client

# Training Room Features



The Training Room is equipped with:

- Recording / streaming system
- Speakers in ceiling to amplify instructor and playback audio from inputs
- Audio
  - Wireless receiver
  - Amplifier
  - Feedback suppressor
  - Processor to automatically mix different sources
- Control processor for linking desktop control panel to other systems
- System to split and send instructor signal to all screens
- Microphone(s) to pick up student voices to record the questions/comments/discussion.
  - Google Ceiling Mic



# Training and Beyond

The training in this room is robust as well are the many uses for the room. The unique open footprint allows better collaborations with learners and lecturers, Large format demonstrations, Events and flexibility which allows an excellent and versatile hub for Talent Development.

What do we use the Training Room for:

- **Software Training** - Unreal, Blender, Maya, Gravity Sketch, Substance Suite, Adobe Creative Cloud apps (Photoshop, Illustrator, Etc.), Google Suite, Office 360, Etc.
- **Pipeline Tools Training**- Proprietary tools, 3rd party tools, Plugin Creation
- **Previs Tools Training and Demos** - VCam, Mocap (Xsens, Move AI), MR Software (Gravity Sketch)
- **Employee Onboarding** (Setup, Tech Demo, Security Enrollment, Mentor Meeting, Employee Checkins)
- **Artist Dailies, Meetings, General Purpos Training**
- **Personal Development Courses**
- **Events**
- **Outreach Programs**





# Project Debrief

The training room has changed a lot from its original concept. Originally conceived out by Andrew Schlusser, and modified and completed by myself based on my teaching experience from the last 20+ years, it was designed to be an open space that could have several functions and could have seats added to the open area when need for special presentations.

Things that were originally planned that would have made it better:

- Track lighting controllable at the instructors station (found small solution with ceiling lights)
- Custom Desks to accommodate the versatile stations (we had to remove 2 learner stations)
- A better equipment cabinet that can be locked up (this was added at a later date)
- Its own wireless hub in addition to the existing 1gb hardwire connections
- A better room mic for the Pearl Recorder integrated with the Meet Mic
- Stands for the Cintiqs, not the arms or flat on the desk
- Older Cintiqs have a problem with indirect connections to hardware (found a hardware workaround)
- MAC Laptops run into limitation problems with too many screens or hardware connected to them (found a hardware input and settings workaround)



# Project Debrief

## Support that was instrumental

### Primarily

- **AV** (The wiring, planning, routing, setting up the rack, server, hardwired 1GB connection, power needs, working with Google on the programming of the Meet System)
- Direct AV Empire Training Room Slack for the first few months of testing and usage to iron out a lot of bugs and fixes

### Secondarily

- **Animtech** (Backend configurations and feedback for setup of Thin Clients)
- **Workplace** (ceiling lighting adjustments and fixes)



**We're here to support your success  
and training needs!**

**Contact us:**

**For a Tour and Demo of the Room Contact:**  
[tcarriere@netflixanimation.com](mailto:tcarriere@netflixanimation.com)